

ORDINANCE NO. 1906

1  
2  
3 AN ORDINANCE amending King County Zoning Code Resolution  
4 No. 25789, as amended, by amending the Zoning Map thereof  
5 adopting a Final Planned Unit Development on certain property  
6 thereon at the request of Group Health Cooperative of Puget  
7 Sound, Division of Land Use Management File No. 411-73-P,  
8 Division # 1.

9  
10 BE IT ORDAINED BY THE COUNCIL OF KING COUNTY:

11 SECTION 1. Group Health Cooperative of Puget Sound petitioned on March 13,  
12 1973, that the planned unit development be adopted on property described in Section  
13 3 below, and this application was assigned Division of Land Use Management File  
14 No. 411-73-P.

15 SECTION 2. The Division of Land Use Management along with the Deputy Zoning  
16 and Subdivision Examiner reviewed this matter on January 18, 1973.

17 SECTION 3. The legal description of the property designated is attached as  
18 Appendix A and is hereby made a part of this ordinance. The above described  
19 property is shown on the attached map which is designated Appendix B and is hereby  
20 made a part of this ordinance. The final planned unit development plot plan is desig-  
21 nated Appendix C and is hereby made a part of this ordinance.

22 SECTION 4. The King County Council does hereby amend King County Zoning  
23 Code, Resolution No. 25789, as amended, by adopting the planned unit development  
24 for that property described and shown in Section 3, Appendices A, B and C above,  
25 to Planned Unit Development, Division # 1 and directs that Area Map W 17-21-4 be  
26  
27  
28  
29  
30

1906

1 modified to so designate.

2 INTRODUCED AND READ for the first time this 26th day  
3 of March, 1973.

4 PASSED at a regular meeting of the King County Council this 28th day  
5 of January, 1974.

6 KING COUNTY COUNCIL  
7 KING COUNTY, WASHINGTON

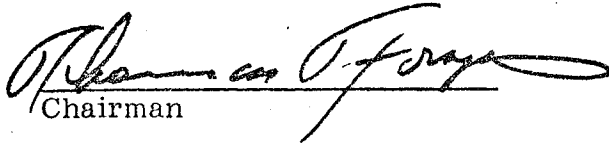
8   
9 Chairman

10 ATTEST:

11   
12 Clerk of the Council

13 DEEMED ENACTED WITHOUT  
14 COUNCIL EXECUTIVE'S SIGNATURE

15 APPROVED this \_\_\_\_\_ day of February, 1974.  
16 DATED: February 8, 1974.

17 \_\_\_\_\_  
18 King County Executive

## APPENDIX A

OVERALL LEGAL

The south 609' + of the north 659' + of the NW 1/4 of the NW 1/4. Less west 328' +  
and also less county roads.

1906

FILE 411-73-P

APPENDIX B

Applicant: GROUP HEALTH COOPERATIVE OF PUBET SOUND

Request: PRELIMINARY PLANNED UNIT DEVELOPMENT  
DIVISION NO. 1

STR: 17-21-4  
Proposed  
Reclassification

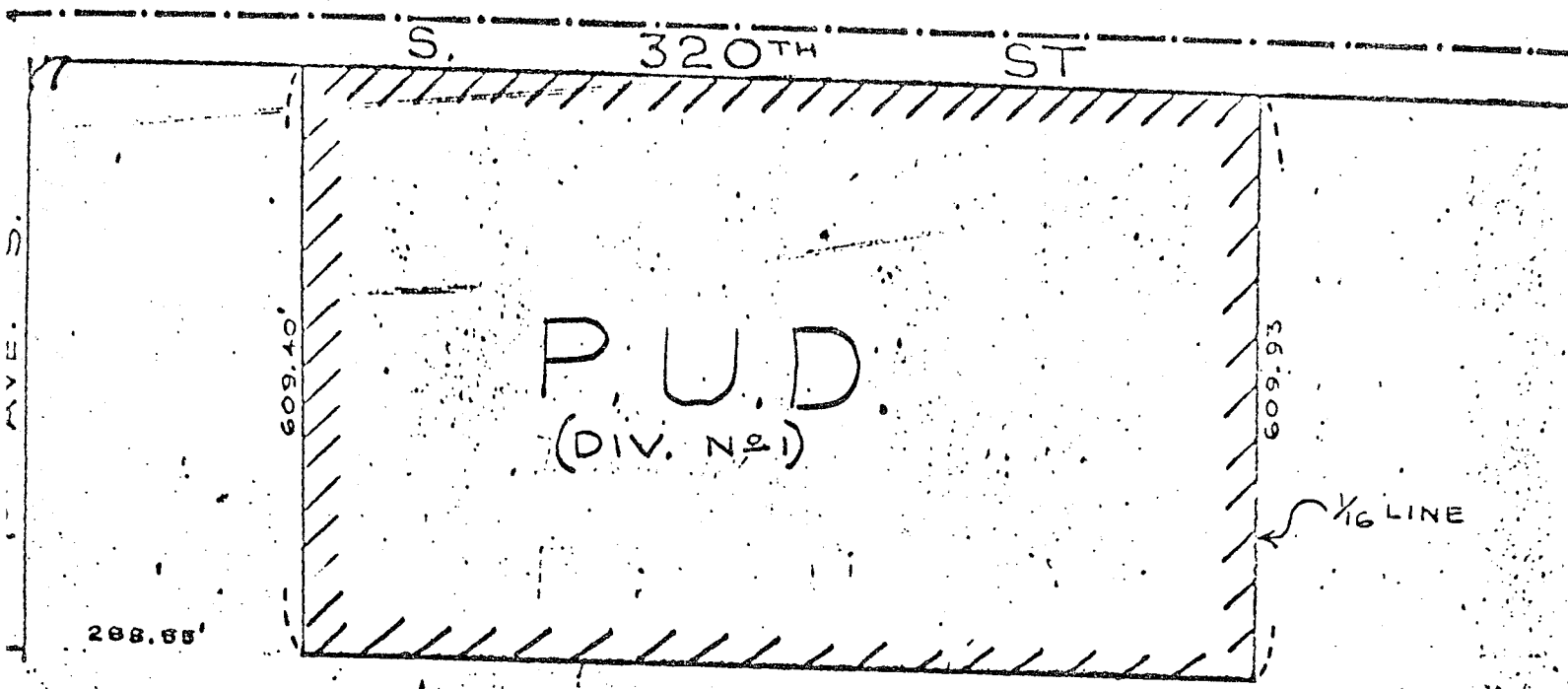

S-R